

# High Flow Check Valves



## Features

- Low flow resistance
- Low opening pressure (contact us for specific values)
- 100 percent tested for back flow
- Positive seal against back flow even at very low backpressure
- Constructed from medical grade acrylic and silicone materials
- Available in other materials on special request
- Offered with both straight and barbed tube fittings
- Miniature valve offered with straight and Luer fittings
- For medical applications, the valves can be ethylene oxide or radiation sterilized
- Steam autoclavable materials available on special request

R-702

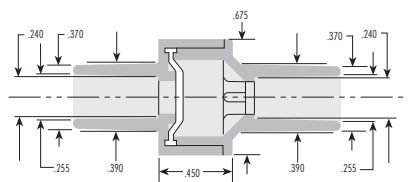

R-701

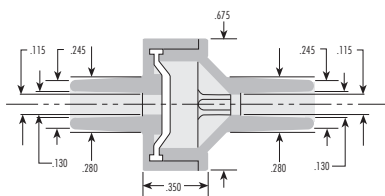

R-711

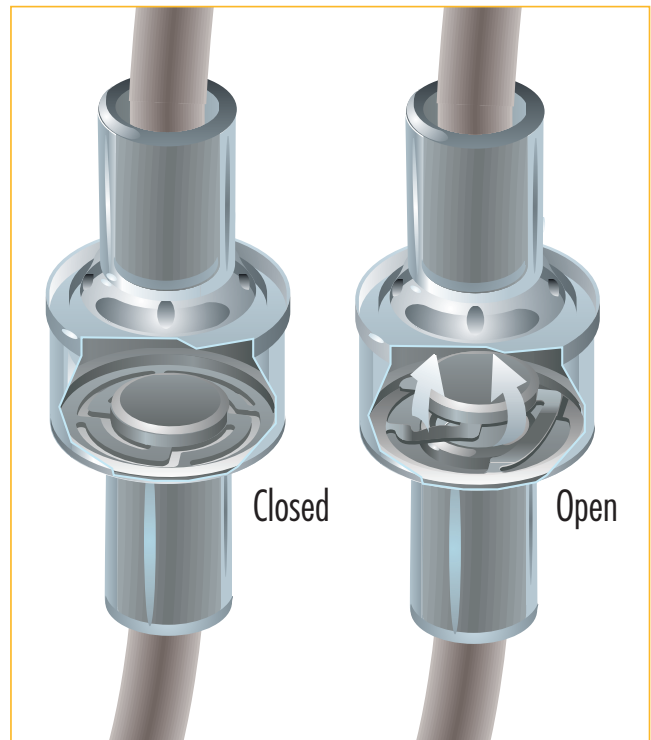
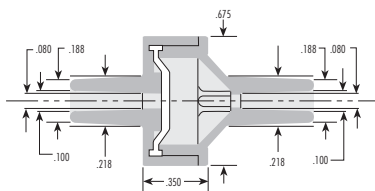

**Notes:**

1. All dimensions on the drawings are in inches. For metric users, 1 inch= 25.4 mm.
2. Pressure conversion: 1 inch of water = 0.0361 psi = 1.868 mm Hg = 0.249 K Pascal



Contact us for **FREE** product samples Tel: 818 341-2525 • Toll Free: 800 220-1876 • Fax: 818 885-8086

Resenex Corporation 9614-F Cozycroft Ave. Chatsworth, CA 91311, USA • Internet: <http://www.resenex.com> • E-mail: [sales@resenex.com](mailto:sales@resenex.com)

## Barbed End Fittings

## & Luer End Fittings

R-721

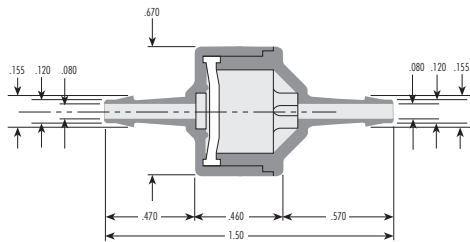

R-725

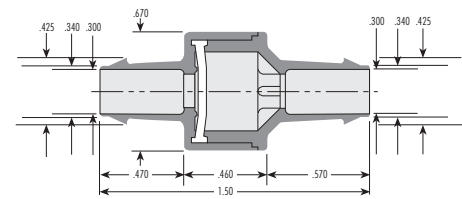

R-722

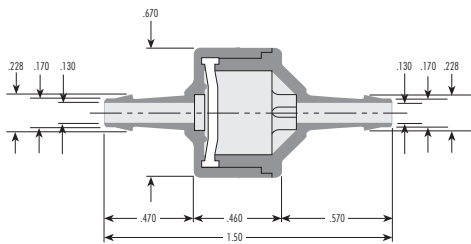

R-731

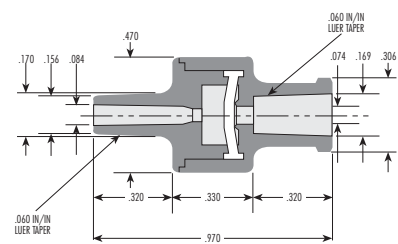

R-723

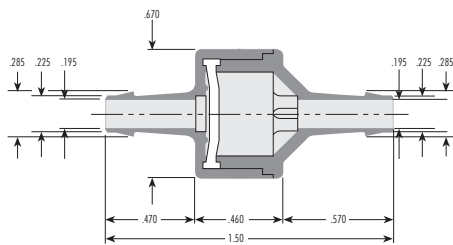

R-732

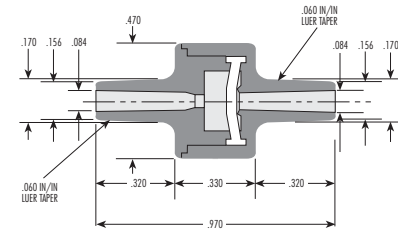

R-724

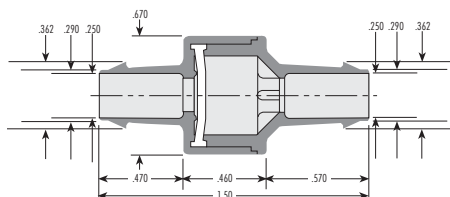

**Notes:**

1. All dimensions on the drawings are in inches. For metric users, 1 inch = 25.4 mm.
2. Pressure conversion: 1 inch of water = 0.0361 psi = 1.868 mm Hg = 0.249 K Pascal

Made in U.S.A. Covered by US Patents 5,176,415, 5,286,067 and 5,727,594. European Patent 0471574. Other patents pending.